



Furhoffs Revit Plugin User guide

21.05.2018

CONTENTS

CHAPTER 1. GENERAL.....	3
ABOUT THIS DOCUMENT.....	3
INSTALLING THE SOFTWARE.....	3
<i>Required third-party software.....</i>	<i>3</i>
<i>Installation.....</i>	<i>3</i>
ADDING UNIT TO REVIT.....	4

CHAPTER 1. GENERAL

ABOUT THIS DOCUMENT

This document contains instructions on using Furhoffs Revit plugin.

The purpose of the plugins to add Furhoffs floor drain devices to Revit project.

INSTALLING THE SOFTWARE

Required third-party software

Revit

- Revit 2017, 2018 or 2019

MagiCAD (optional)

- MagiCAD for Revit 2018 (with Revit 2017 and 2018)
- MagiCAD for Revit 2019 (with Revit 2017, 2018 and 2019)

Installation

1. Download 64-bit installation package from:
<https://portal.magicad.com/Download/ProductSearch?searchStr=Furhoffs&categoryId=3>
2. Run the Furhoffs plug-in installer on your workstation

Administrator privileges are recommended for installation.

Information for network administrators:

Plugin requires connection to Furhoffs web site. Internet Explorer control is used to browse web pages from <http://magicad.furhoffs.se/Furhoffs/Main.aspx>.

Standard HTTP GET (TCP, default port 80 should be used) method is used to retrieve files from the server. GET response includes file (mime application/octet-stream). Your network firewall should allow such connections (plugin runs inside Revit process).

ADDING UNIT TO REVIT

1. Click *Add-ins* ribbon tab and *Floor drain* button to open Furhoffs selection software in browser.

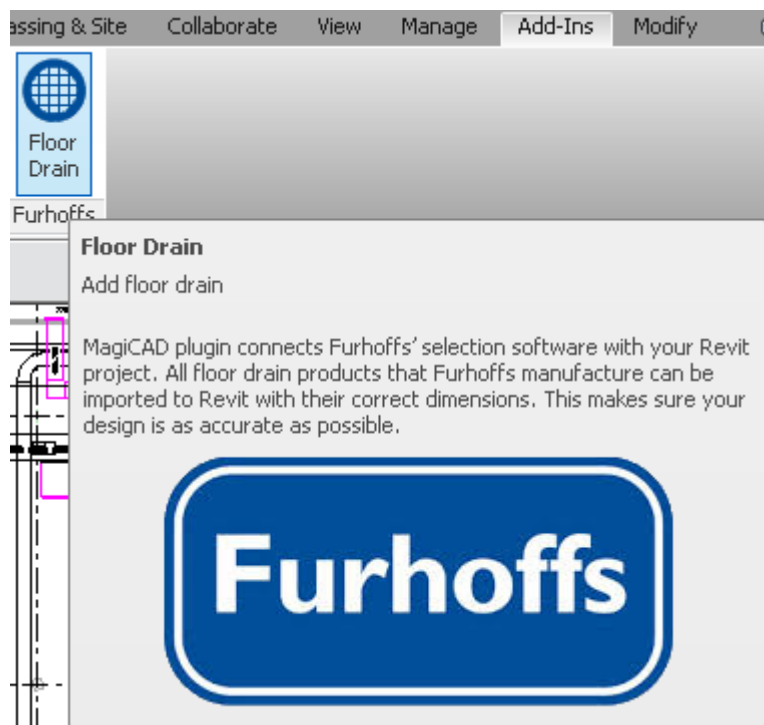

2. Select device from product series combo. Size fields may vary depending on selected product series. Some products have only one length and width field while other products have more sizes to set. User should also choose connection type, dimension and floor type. Press then Export button in dialog down right corner to export it to Revit.

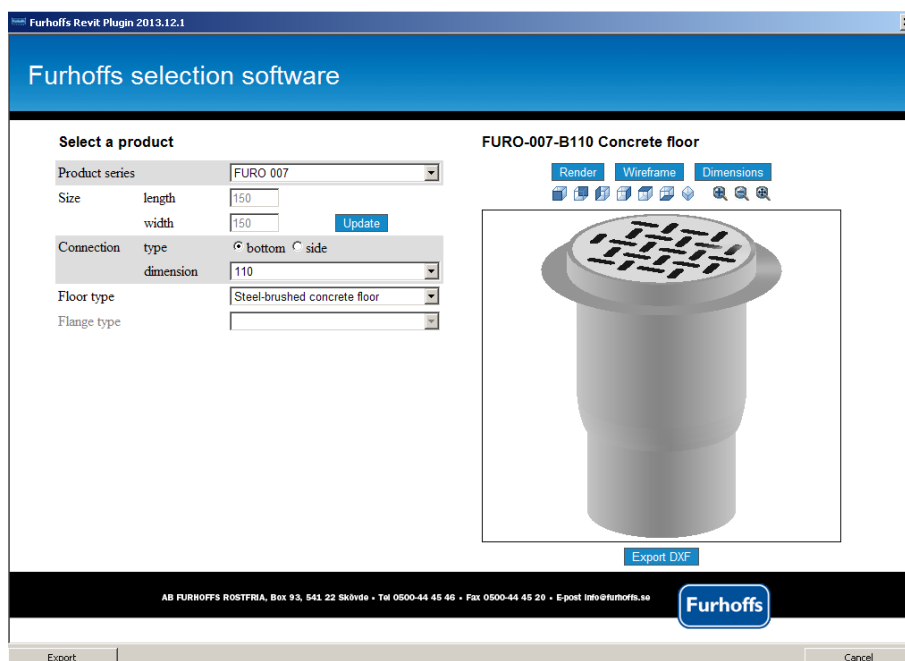

3. Add product to Revit.

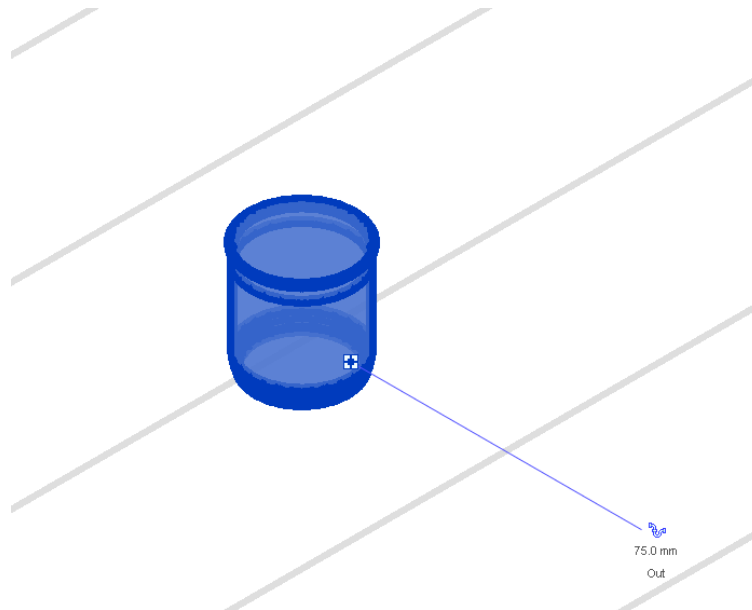

4. Click Edit type in properties window to see more device data.

Type Properties

Family: Load...

Type: Duplicate...
Rename...

Type Parameters

Parameter	Value
concLocR	118.3
concLocPhi	0.000°
concDirTheta	90.000°
concDirPhi	0.000°
Identity Data	
revitCategoryNmb	240
magiProductId	007-0150-0150S075CF
magiProductFamilyId	007-0150-0150S075CF
magiPartTypeId	351
VersionID	1.0/Furhoffs/FURHOFFS_FURO007_
Description	Floor drain for areas with lighter load
Assembly Code	
Keynote	
Model	
Manufacturer	Furhoffs
Type Comments	
URL	http://www.furhoffs.se/default.asp?
Assembly Description	
Type Mark	
Cost	
magiProductCode	FURO-007-575 Concrete floor
OmniClass Number	
OmniClass Title	

<< Preview OK Cancel Apply

5. Selected product is added to Revit families under "Plumbing Fixtures"

